

AMENDMENTS TO ZONING MAP

REF. NO.	NEW	OLD	DATED
1	BUS. AAA	RES. B	14 JAN. 1965
2	BUS. AAA	BUS. A & BUS. B	14 JAN. 1965
3	BUS. AAA	BUS. A & BUS. B	14 JAN. 1965
4	RES. A	BUS. A	19 MAY 1965
5	RES. B	RES. A	9 SEPT. 1968
6	BUS. A	RES. A	3 SEPT. 1968
7	MULTIPLE DWELLING "B" (C)	COMMERCIAL OR LIGHT MANUFACTURING "A"	10 MAY 1968
8	RECREATION & LIMITED COMMERCIAL "C"	COMMERCIAL OR LIGHT MANUFACTURING "A"	10 MAY 1968
9	MULTIPLE DWELLING "B" (C)	RES. A	4 NOV. 1974
10	RES. B	RES. A	23 SEPT. 1974
11	RES. A	MULTIPLE DWELLING "B" (C)	8 SEPT. 1975
12	U.S. MULTIPLE DWELLING "C"	RES. A	19 JULY 1976
13	U.S. MULTIPLE DWELLING "C"	RES. B	29 OCT. 1979
14	RES. B	RES. A & B	15 FEB. 1981
15	RES. A-M	RES. C	24 JAN. 1983
16	RES. A & B	BUS. A	25 OCT. 2004
17	RES. B	RES. A	8 NOV. 2004

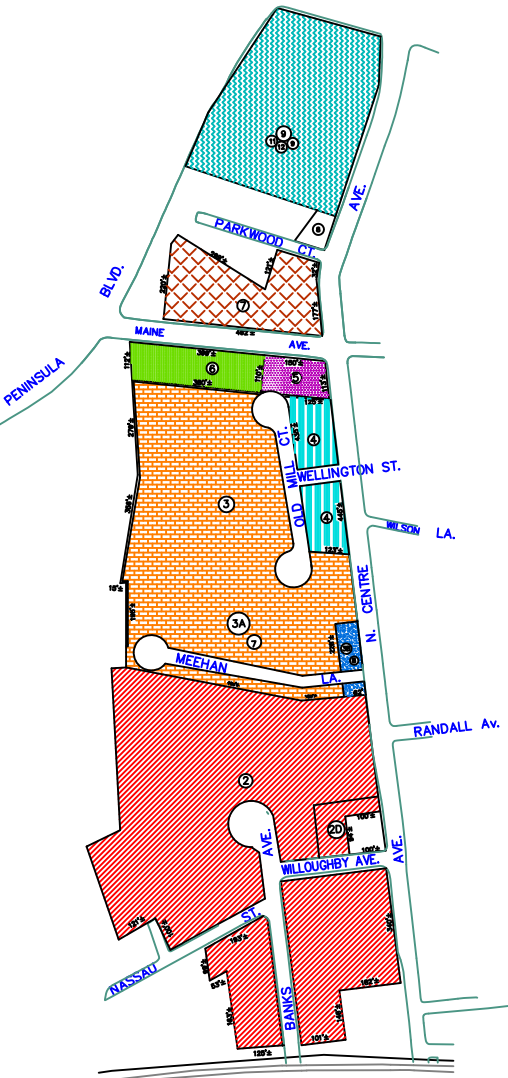

- 1 URBAN RECREATION AND LIMITED COMMERCIAL "C"
- 2 URBAN RECREATION AND LIMITED COMMERCIAL "C"
- 3 URBAN RECREATION AND LIMITED COMMERCIAL "C"
- 3A URBAN RECREATION AND LIMITED COMMERCIAL "C"
- 4 URBAN RECREATION AND LIMITED COMMERCIAL "C"
- 5 URBAN RECREATION AND LIMITED COMMERCIAL "C"
- 6 URBAN RECREATION AND LIMITED COMMERCIAL "C"
- 7 URBAN RECREATION AND LIMITED COMMERCIAL "C"
- 8 URBAN RECREATION AND LIMITED COMMERCIAL "C"
- 9 URBAN RECREATION AND LIMITED COMMERCIAL "C"
- 10 URBAN RECREATION AND LIMITED COMMERCIAL "C"
- 11 URBAN RECREATION AND LIMITED COMMERCIAL "C"
- 12 URBAN RECREATION AND LIMITED COMMERCIAL "C"
- 13 URBAN RECREATION AND LIMITED COMMERCIAL "C"
- 14 URBAN RECREATION AND LIMITED COMMERCIAL "C"
- 15 URBAN RECREATION AND LIMITED COMMERCIAL "C"
- 16 URBAN RECREATION AND LIMITED COMMERCIAL "C"
- 17 URBAN RECREATION AND LIMITED COMMERCIAL "C"

AMENDMENTS TO U.R. LAND USE

OLD	NEW	DATE
2	3 A	29 APR. 1968
2	3 B	29 APR. 1968
2	2 D	4 JAN. 1971

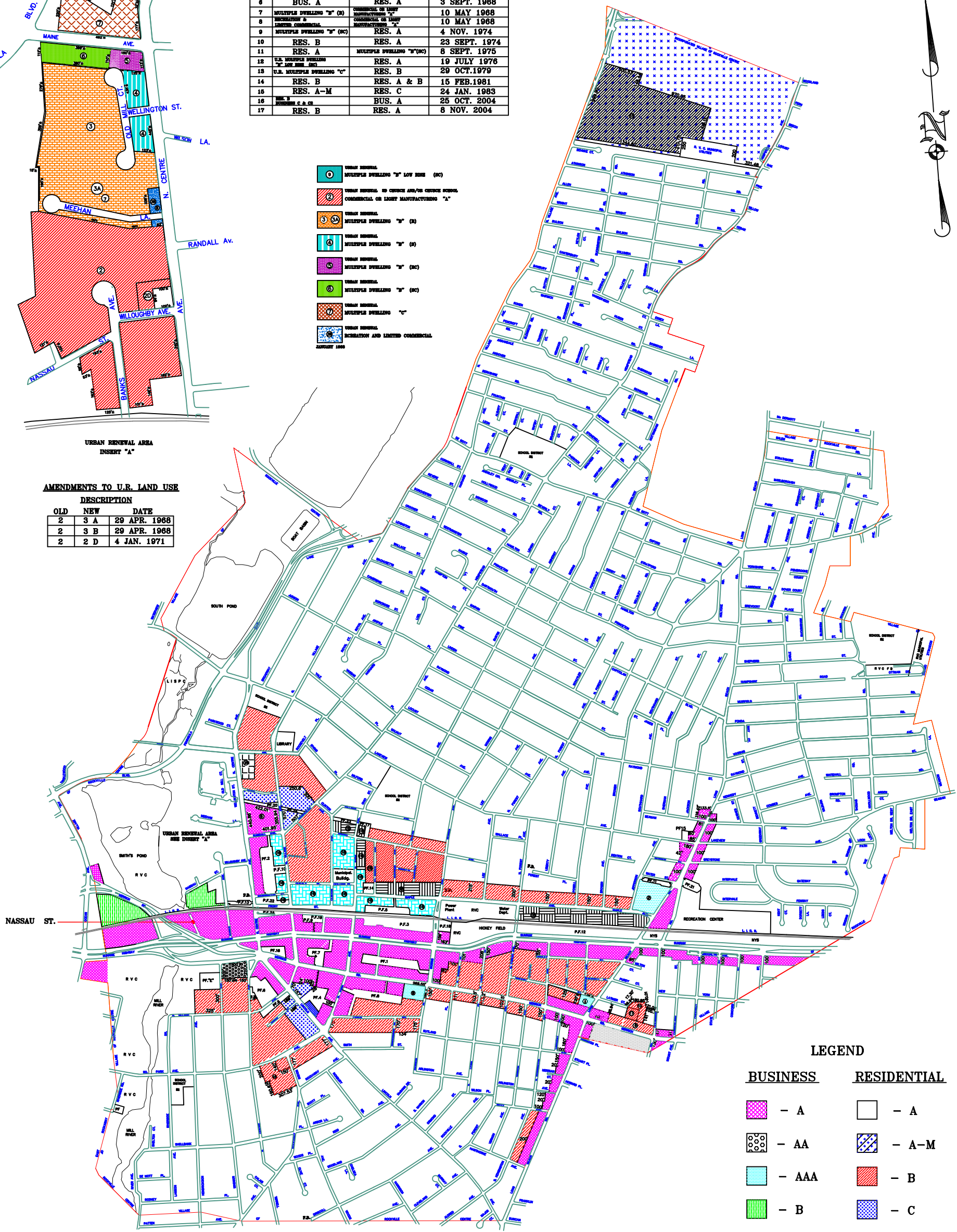

LEGEND

BUSINESS		RESIDENTIAL	
[Pink Box]	- A	[White Box]	- A
[Blue Box]	- AA	[Blue Box]	- A-M
[Light Blue Box]	- AAA	[Red Box]	- B
[Green Box]	- B	[Blue Box]	- C
[Light Blue Box]	- C		
[Grid Box]	- C-2		

ROAD CONFIGURATION CHANGE

* DESCRIPTION	DATE
A OLD MILL CT. U.R. NEW STREET	12 NOV. 1964
B WELLINGTON ST. U.R. NEW STREET	12 NOV. 1964
C PARKING FIELD 18 NEW P.F. 18	AUG. 1968
D MERRHAN LA. U.R. NEW STREET	14 FEB. 1968
E PARKING FIELD 19 NEW P.F. 19	AUG. 1968
F LINCOLN AV. CENTER TO ROCKAWAY	3 JAN. 1969
G SO. PARK AV. LENOX TO PARK PL.	3 JAN. 1969
H MORRIS AV. S/O SUNSHINE HWY.	19 FEB. 1969
J PARKING FIELD 14 EXT. OF P.F. 14	3 NOV. 1969
K MURRAY CT. NEW STREET	8 NOV. 1971
L CLAUDE ST. DISCONTINUED	15 JULY 1965
M ROYAL COURT NEW DEAD END	
N MELTON DRIVE NEW STREET	12 NOV. 1968
O WARWICK ROAD NEW DEAD END	12 NOV. 1968
P NASSAU STREET DISCONTINUED-LINE TO MERRICK RD.	SEPT. 1969

ZONE SETBACK CHANGE

* LOCATION	WAS	NOW
F P.F. 8 S/S	175'	150'±
F LINCOLN CT. S/S	200'	183'±
F SO. VILLAGE AV. S/S	66'	70'±
F LINCOLN AV. E/S	50' (150')	157'±
G LINCOLN AV. W/S	200'	177'±
G PARK PL. E/S	200'	177'±

SQ. MILES 3.332812
AREA 2133 ACRES

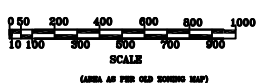

Incorporated Village of Rockville Centre Department of Public Works

AMENDED BUILDING ZONE MAP

Scale: 1"=600' Date: 5/20/08 Drawn By: CK. Dwg. Z2